

**500 mm White & Stainless Steel Tandembox
 Inner Drawers**

50kg

HEAD OFFICE

94 BELL STREET,
 PRESTON VIC 3072
 TELEPHONE: (03) 9495 8900
 FACSIMILE: (03) 9416 8878
 EMAIL: sales@wilbrad.com.au

NSW SHOWROOM

UNIT 1/41-43 VORE STREET
 SILVERWATER NSW 2128
 TELEPHONE: (02) 9737 0255
 FACSIMILE: (02) 9647 2474
 EMAIL: Sydney@wilbrad.com.au

TAS SHOWROOM

45 SUNDERLAND STREET,
 MOONAH TAS 7009
 TELEPHONE: (03) 6272 9400
 FACSIMILE: (03) 6272 9600
 EMAIL: Tasmania@wilbrad.com.au

QLD SHOWROOM

UNIT 2/60 ENTERPRISE PLACE,
 TINGALPA QLD 4173
 TELEPHONE: (07) 3890 8611
 FACSIMILE: (07) 3890 3375
 EMAIL: Brisbane@wilbrad.com.au

Website

www.wilbrad.com.au



**Quality
 Endorsed
 Company**

ISO 9002
 LIC NO QEC 8260
 Standards Australia

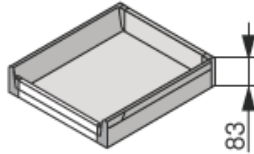

ORDER CODE
 WHITE
TANDEMBOX WB5609

STAINLESS
TANDEMBOX WB5621

Description:
 83 mm Inner Drawer with
 Blumotion 500 mm

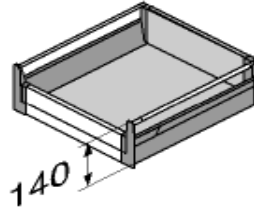

ORDER CODE
 WHITE
TANDEMBOX WB5709

STAINLESS
TANDEMBOX WB5721

Description
 83 mm Inner Drawer + Single
 Gallery Rail with Blumotion
 500 mm

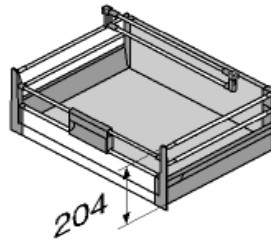

ORDER CODE
 WHITE
TANDEMBOX WB5809

STAINLESS
TANDEMBOX WB5821

Description
 83 mm Inner Drawer + Double
 Gallery Rail with Blumotion
 500 mm

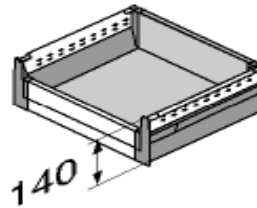

ORDER CODE
 WHITE
TANDEMBOX WB5909

STAINLESS
TANDEMBOX WB5921

Description:
 83 mm Inner Drawer + Gallery Rail +
 64 mm Single Wall Boxside with
 Blumotion 500 mm

500 mm White & Stainless Steel Tandembox Inner Drawers

50kg

HEAD OFFICE

94 BELL STREET,
PRESTON VIC 3072
TELEPHONE: (03) 9495 8900
FACSIMILE: (03) 9416 8878
EMAIL: sales@wilbrad.com.au

NSW SHOWROOM

UNIT 1/41-43 VORE STREET
SILVERWATER NSW 2128
TELEPHONE: (02) 9737 0255
FACSIMILE: (02) 9647 2474
EMAIL: Sydney@wilbrad.com.au

TAS SHOWROOM

45 SUNDERLAND STREET,
MOONAH TAS 7009
TELEPHONE: (03) 6272 9400
FACSIMILE: (03) 6272 9600
EMAIL: Tasmania@wilbrad.com.au

QLD SHOWROOM

UNIT 2/60 ENTERPRISE PLACE,
TINGALPA QLD 4173
TELEPHONE: (07) 3890 8611
FACSIMILE: (07) 3890 3375
EMAIL: Brisbane@wilbrad.com.au

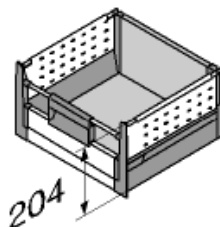

ORDER CODE

WHITE
TANDEMBOX WB6009

STAINLESS
TANDEMBOX WB6021

Description:
83 mm Inner Drawer + Gallery Rail
+ 128 mm Single Wall Boxside
with Blumotion 500 mm

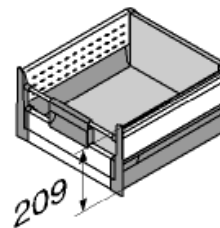
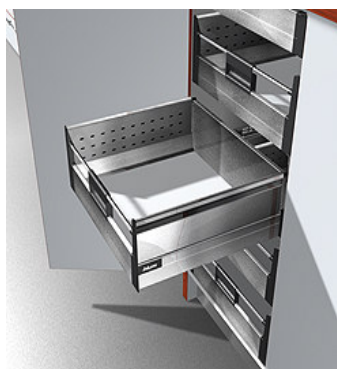

ORDER CODE

WHITE
TANDEMBOX WB6109

STAINLESS
TANDEMBOX WB6121

Description
83 mm Inner Drawer + Gallery
Rail + 128 mm Double Wall
Boxside with Blumotion
500 mm

Website

www.wilbrad.com.au



**Quality
Endorsed
Company**

ISO 9002
LIC NO QEC 8260
Standards Australia