

# Emotion remote control system

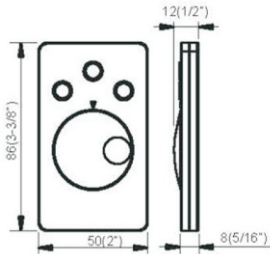

Dimension in mm (inch)

Remote-controller transmitter, KZQ-8YKC-1



Holder

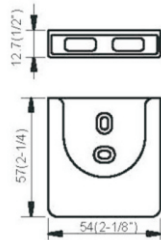

Receiver KZQ-9XJC

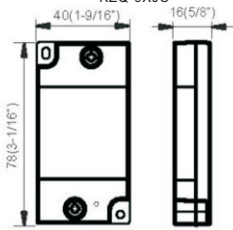

working frequency : 2.4GHz  
 power: CR2032(3V) button lithium battery  
 Remote range: ≤15m  
 Ta: 0°C ~ 35°C  
 Memory function: Last setting will be saved  
 Switching power: Up to 2.5A.

Application: To control the color temperature adjustable LED lamps  
 Load: DC 12V or 24V color temperature adjustable LED lamps

Rated supply	Rated load
12VDC	30W
24VDC	60W

1

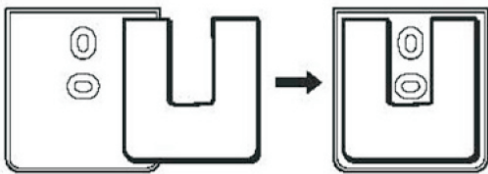

2

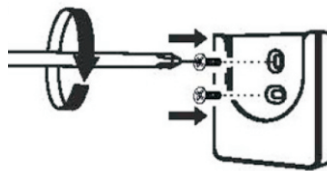

3

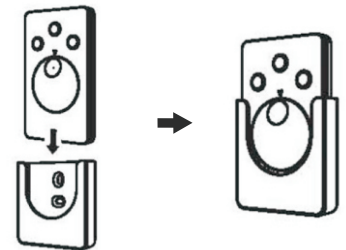

4

Battery installation

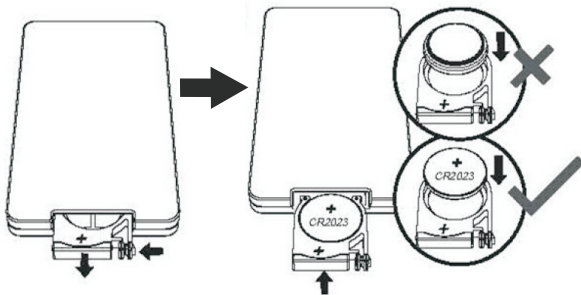

5

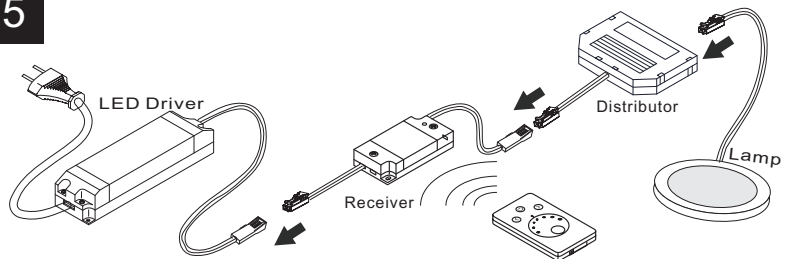

6

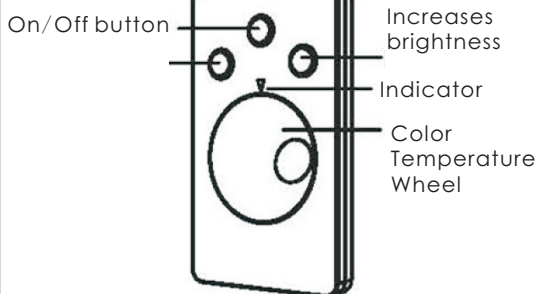

6.a

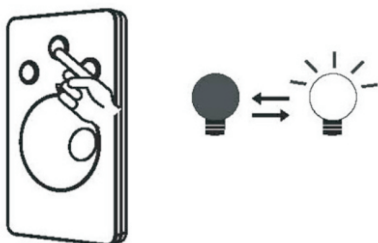

6.b

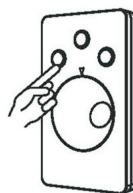

Press to decrease by 10% brightness, there are 10 brightness levels.



Hold down to decrease brightness gradually down to 10%.

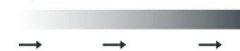

6.c



Press to increase by 10% brightness, there are 10 brightness levels.



Hold down to increase brightness gradually down to 10%.

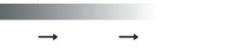

6.d

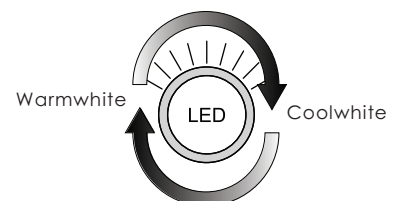

Rotate to select the desired color temperature with the indicator line.

**7** The transmitter can control multi route color temperature adjustable LED Lamps with receiver within the remote range

If you need this function , please go with step8 and step9.

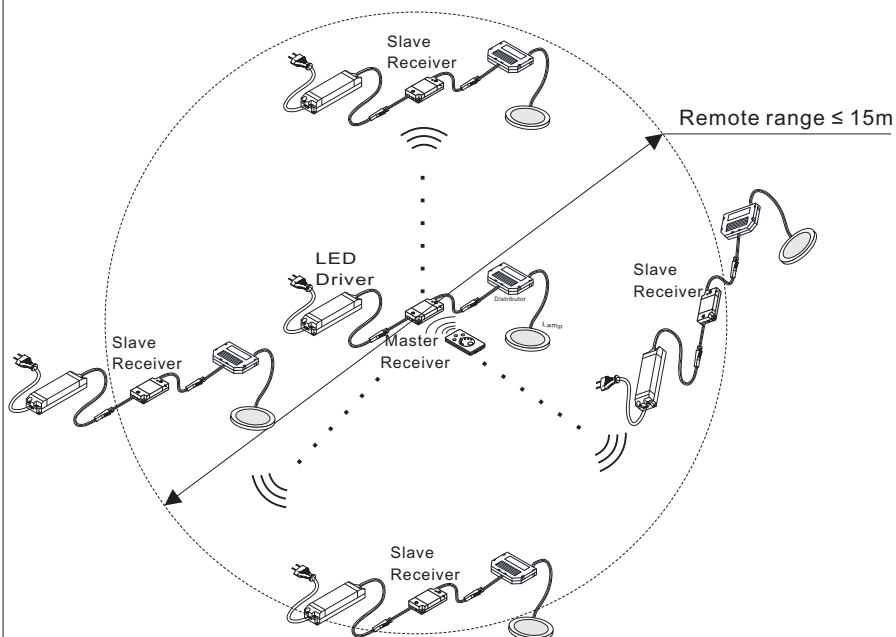

**8** Match the slave receiver to transmitter

**8.a** Connect color temperature adjustable LED lamps

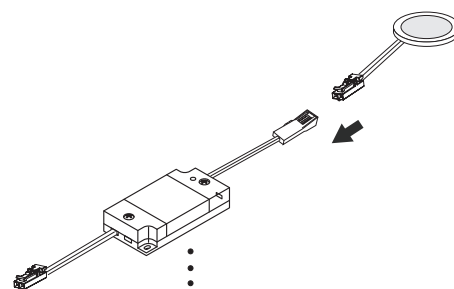

**8.b** Connect to power and press the test button

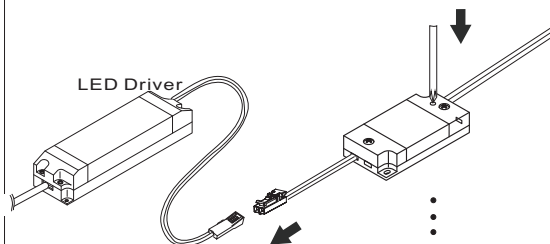

**8.c** The indicator light turns on(The controller will exit matching setting mode after 1 minute of inactivity, and indicator light will turn off)

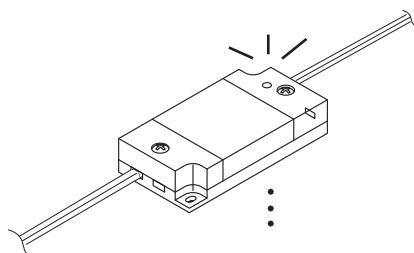

**8.d** Press the On/Off button for more than 5 seconds

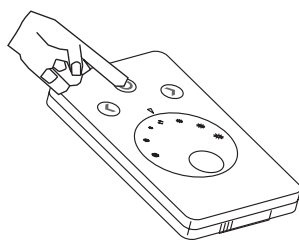

**8.e** If the indicator light flashes and turns off, the transmitter works well with the receiver.

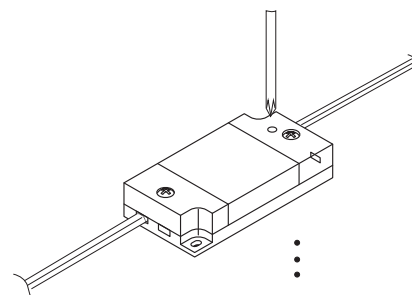

**9** Match the master receiver to transmitter

**9.a** Connect color temperature adjustable LED lamps

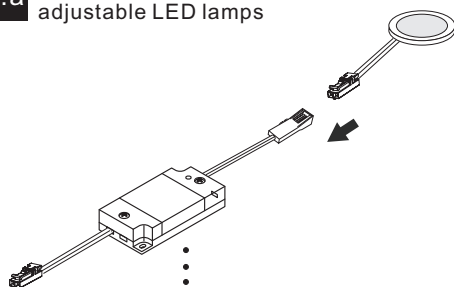

**9.b** Connect to power and press the test button for 5 seconds

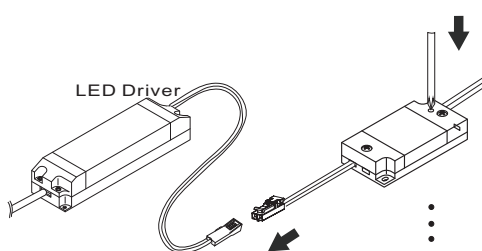

**9.c** The indicator light turn on

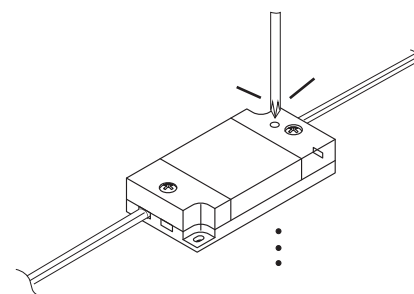

**9.d** If the indicator light flashes after 5 seconds, the transmitter works well with the receiver

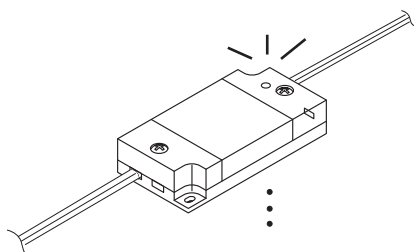

**Memory function**

Notice: Memory function will take effect under the receiver working well at least 60s while rotating the color wheel.

**Sleeping function**

The remote will go dormant after 60 seconds of inactivity. Press any button to reactivate the remote.

**Master receiver setting function**

Notice: Only one master receiver allowed in the wireless network. If the slave receiver need to be setted as master, it can be setted according to the "Match the master receiver to transmitter" step, and the original master receiver should be power on.